

# KENT PRIDE TC

Mineral RO™ Water Purifier  
Double Purification by RO + UF

**KENT**  
*Mineral RO™*  
Water Purifiers  
HOUSE of PURITY

## Instructions Handbook



**Mineral RO™ TECHNOLOGY**  
Removes Dissolved Impurities  
Retains Essential Minerals  
Multiple Purification

**RO + UF + TDS Control**

Kent Deta Hai

**Sabse  
Shudh Paani**



Marketed by:  
**KENT RO SYSTEMS LTD.**  
E-6, 7 & 8, Sector-59, Noida, U.P.-201 309, India.  
E-mail: [sales@kent.co.in](mailto:sales@kent.co.in) | Website: [www.kent.co.in](http://www.kent.co.in)

Manufactured by:  
**KENT RO SYSTEMS LTD.**  
1) Khasra No. 93, Village-Bantakhedi, Tehsil-Roorkee,  
District-Haridwar, Uttarakhand-247 668, India.  
2) A-6, Sector-87, Noida-201 305, U.P., India.

For customer complaints, contact our Customer Care Officer at:  
E-6, 7 & 8, Sector-59, Noida, U.P.-201 309, India. Call : 92-789-12345  
E-mail: [service@kent.co.in](mailto:service@kent.co.in) or visit us at [www.kent.co.in](http://www.kent.co.in)

Reverse Osmosis Water Purifier with Ultra-Filtration Process & TDS Controller.  
Mineral RO™ and © 2005-2019 KENT RO Systems Ltd.  
The process & purifier is patented vide patent no. 199716.

Welcome  
to KENT

Dear Customer,

Welcome to the world of the **KENT**, leaders of water purification industry in India. With a **KENT** product, you have all the reasons to smile, because at **KENT** we take pride in the quality and laboratory-tested performance of our products.

We are confident that your decision to own **KENT Pride TC Mineral RO™ Water Purifier** will go a long way in serving you with pure and mineral enriched drinking water, thus keeping you and your family in good health. We assure you that you will be satisfied with its trouble-free performance and quality which comes without any compromise.

This manual is an effort towards familiarising you with the operation and maintenance of **KENT Pride TC Mineral RO™ Water Purifier**. Before operating the unit, please read it thoroughly and retain it for future reference. To ensure that the warranty of your water purifier is effective, fill up the enclosed warranty card and send the installation report within 15 days of purchase. Should you need further assistance, do not hesitate to contact your nearest **KENT** dealer or branch.

Best Wishes,

KENT RO SYSTEMS LTD.

## Table of Contents

1. KENT TECHNOLOGY - A Breakthrough in Water Purification	1
2. Salient Features	1
3. Items in the Box	1
4. Important Instructions	2
5. Reverse Osmosis Process	3
6. UF Process	3
7. Water Flow Diagram	4
8. Electrical Circuit Diagram	4
9. Automatic Operation	5
10. Installation Instructions	5
11. TDS Adjustment	6
12. Starting-up the Purifier	7
13. Recommended Usage of Rejected Water	7
14. Maintenance	7
15. Important Safety Instructions	8
16. Technical Specifications	9

## KENT TECHNOLOGY

### A Breakthrough in Water Purification\*

KENT proudly presents **KENT Pride TC Mineral RO™ Water Purifier** - its new and advanced domestic water purifier which provides purer & healthier drinking water.

The futuristic **KENT PrideTC Mineral RO™ Water Purifier**, developed at **KENT** laboratory, broadly comprises of the state-of-the-art RO+UF+TDS Control System. The initial purification by RO membrane with porosity as fine as 0.0001 microns reduces even dissolved impurities (hard salts, heavy metals etc.). Double purification by UF membrane gives additional protection from deadly harmful micro-organisms. Moreover, the patented TDS Control System intelligently retains essential natural minerals in the purified water, thus, taking total care of your health and well-being.

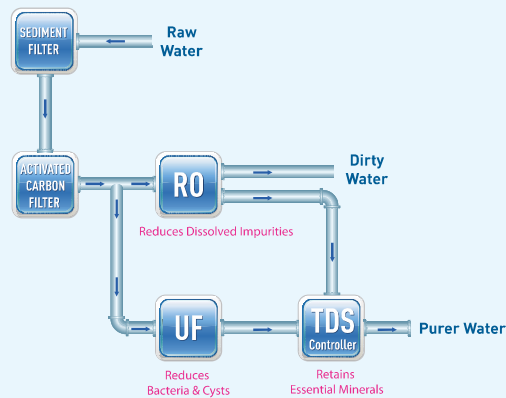

### Salient Features of KENT Pride TC Mineral RO™ Water Purifier







- |  |  |
|--|--|
| <ul style="list-style-type: none"> <li>■ Wall mounted KENT technology water purifier</li> <li>■ Purification process by RO+UF+TDS control makes water 100% pure</li> <li>■ TDS Control System* allows adjustment of TDS level of purified water</li> <li>■ 8L storage tank with water level indicator</li> <li>■ Vertically mounted SMPS for protection</li> <li>■ RO and UF membranes fused inside membrane housing to prevent tampering</li> </ul> | <ul style="list-style-type: none"> <li>■ Push-fit components for leak-proof &amp; maintenance-free performance</li> <li>■ Fully automatic operation with auto-on and auto-off function</li> <li>■ ABS construction for corrosion-free life span</li> <li>■ Suitable for purification of brackish / tap water / municipal water supply</li> <li>■ Compact design needs lesser space for installation</li> </ul> |
|--|--|

### Items in the Box

- |  |                |
|--|----------------|
| 1. <b>KENT Pride TC Mineral RO™ Water Purifier</b> | : 01 No.       |
| 2. 3-Way Connector                                 | : 01 No.       |
| 3. S.S. Ball Valve                                 | : 01 No.       |
| 4. Food Grade Pipe ¼ inch (Blue)                   | : 2.5 m        |
| 5. Food Grade Pipe ⅜ inch (White)                  | : 2.5 m        |
| 6. Screws & Plastic Inserts                        | : 02 Nos. each |
| 7. Instruction Manual                              | : 01 No.       |
| 8. Sticker Center Drill                            | : 01 No.       |

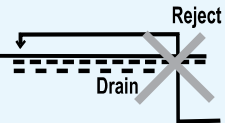
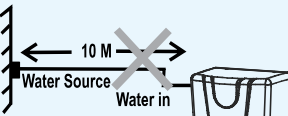
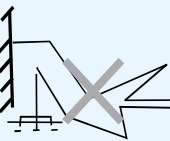
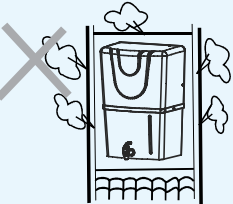
\* Tested & certified by TUV-SUD South Asia (P) Ltd.

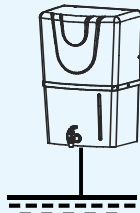
## Important Instructions

 <p>Avoid exposure to direct sunlight and installation in damp areas.</p>	 <p>Make sure that the temperature of the water entering the purifier is between 10-40° C.</p>
 <p>Make sure that the reject water pipe is not placed at a level higher than the system, otherwise it may flow backwards into the purifier.</p>	 <p>Maximum distance between the water source and the purifier should not be more than 3 meters.</p>
 <p>Avoid sharp bends in the pipe fittings. Do not bend or block the reject water pipe.</p>	 <p>Do not confine the purifier in a cabinet.</p>
 <p>In case of not using the purifier for more than two days, kindly switch off the power supply and drain the storage tank.</p>	 <p>To keep the storage tank clean, it should be drained once in 15 days.</p>
 <p>Always use genuine KENT spares for optimum performance.</p>	 <p>Do not try to service the purifier on your own. Instead, call a technician for help.</p>

## Reverse Osmosis Process

The Reverse Osmosis process, also known as hyper filtration, is the finest filtration process known till date. The process ensures the reduction of particles as small as ions from a solution. The Reverse Osmosis process uses a semi-permeable membrane to reduce salts from potable / brackish water. In Reverse Osmosis, water pressure is applied to the impure water inlet resulting in the squeezing of purer water from concentrated end of the membrane towards the diluted end. Dissolved salts present in the water in the form of charged ions get repelled by the RO membrane and are not allowed to pass through. Similarly, bacteria and germs are also blocked by the ultra fine pores of the RO membrane. These rejected impurities, suspended on the concentrated end of the membrane, are then washed away as a stream of waste water, thus preventing the membrane from clogging.

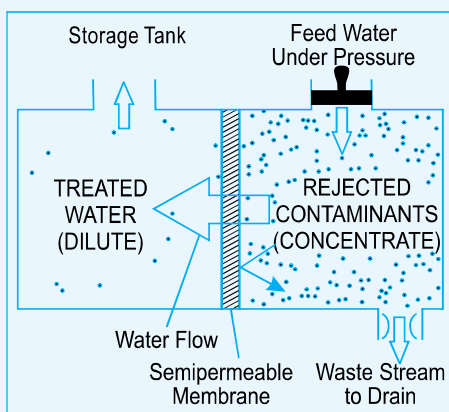

## UF Process

Ultra Filtration is a separation process that uses membranes with pore size in the range of 0.1 to 0.01 micron. UF membrane removes high molecular-weight substances, colloidal materials and organic/inorganic polymeric molecules including bacteria and viruses. Low applied pressure is therefore sufficient to achieve high flux rates from an Ultra Filtration membrane.

## Warranty Card

Product: KENT PRIDE TC

Product Code: 11087

It is certified that KENT RO Water Purifier purchased as under carries 1 Year Warranty + 3 Years of Free Service\*. (Visit/Service charges will not be charged, however parts if replaced shall be charged)



Serial No. ....

Purchase Date ..... Installation Date .....

Service Provider's  
Name & Address  
with Stamp

\*To avail this scheme of 3 Years of Free Service, customer must download the KENT Service App at the time of installation. Also future service request must be raised via KENT Service App to avail free service. Terms & Conditions applicable are mentioned overleaf.



Marketed by: KENT RO SYSTEMS LTD.

E-6, 7 & 8, Sector-59, Noida, U.P.-201 309, India. E-mail: service@kent.co.in | Website: www.kent.co.in | Customer Care: 92-789-12345



## Terms & Conditions of Warranty

KENT warrants all new products manufactured by it to be free from defects in material and workmanship under normal usage and service from the date of purchase as under:

1. It is essential for the customer to download the KENT Service App either on Android or iOS and the customer should lodge a service request via App only.
2. In case of emergency during the warranty period, the customer may lodge a service request at our Call Centre Ph. 92-789-12345.
3. The warranty period commences from the date of installation by the first end-user. During this warranty period of one year, KENT Purifiers or its Authorised Service Provider (ASP) will replace or repair any part of KENT Purifiers, that in the opinion of KENT Purifiers or its ASP, would be defective in operation due to faulty material or workmanship (i.e. manufacturing defects) with the exception of consumables such as Sediment Filter, Carbon Filter and RO/UF Membrane. However, if the RO/UF Membrane gets clogged within first one year and/or if the filters get clogged within first six months, they shall be cleaned / repaired / replaced at no extra charge.
4. In addition to this, KENT will also provide free service for a period of next 3 years, wherein Visit/Service charges will not be charged, however parts if replaced shall be charged.
5. Visit/Service charges will not be charged only for customers residing within 25kms of municipal limits, for other areas additional charges shall be applicable.
6. The product's plastic body is not covered under warranty and hence, it must be handled with care to guard against breakage.
7. The original purchaser of the unit can avail services under warranty at the point of sale, by producing the damaged part(s) along with the original invoice.
8. This warranty is void if the unit is not operated under normal municipal water or well water conditions or is subjected to the temperature above 40°C.
9. Product returned to KENT Purifiers or its ASP for warranty examination must be shipped freight prepaid.
10. KENT Purifiers or its ASP shall not be held liable for claims exceeding the cost of repair of the defects in workmanship.
11. This warranty agreement shall not be interpreted to render KENT Purifiers or its ASP liable for injuries or damages of any kind-direct, consequential or contingent to persons or property.
12. KENT Purifiers or its ASP shall not be held responsible by representative or buyer for failure to abide by any of the obligations of this warranty agreement if such failures are the result of circumstances of Forces Majeures: such as, but not limited to, floods, earthquakes, transportation strikes, labour disputes with outside suppliers or any other conditions beyond the control of KENT Purifiers or its ASP.
13. KENT Purifiers or its ASP shall not be held liable for repair or alterations made without prior written approval; for products clogged by suspended matter, precipitates or biological growth; or for failures resulting from the lack of proper maintenance.
14. KENT Purifiers or its ASP cannot and shall not be held liable for any sickness or illness due to the consumption of drinking water from any water purifier supplied by KENT Purifiers, since KENT Purifiers or its ASP does not have any control over the maintenance and usage of water purifier.
15. This warranty agreement excludes all products/ component parts or damage to any part of this water purifier which, in the opinion of KENT Purifiers or its ASP, have been subjected to misuse; misapplication; negligence; alteration; accident or operation contrary to our instructions, incompatibility with accessories not installed by KENT Purifiers or its ASP, or that have been repaired with component parts other than those manufactured by or obtained from KENT Purifiers or its ASP. Damage caused by freezing, flood, fire or Act of God is not covered by this warranty. In all such cases regular charges will apply. This limited warranty does not include service to diagnose a claimed malfunction in this unit.
16. KENT Purifiers reserves the right to alter or improve design and specifications at any time, without any contingent obligations to prospective buyers or owners of the products previously sold.
17. Any disagreements and obligations based upon the purchase of KENT Purifiers products and thereby imposed on KENT Purifiers or its ASP shall be governed by and construed according to the laws of INDIA and subject to the jurisdiction of Delhi Courts only.
18. KENT Purifiers or its ASP assumes no warranty liability in connection with this water purifier other than that specified herein. This warranty is in lieu of all other warranties, expressed or implied, including warranties of fitness for a particular purpose. KENT or its ASP does not authorise any person or representative to assume for them any other obligations on the sale of this water purifier.
19. Under no circumstances, the liability of KENT Purifiers or its ASP shall exceed the value of the product.
20. Under no circumstances are the terms mentioned above negotiable and no employee of KENT Purifiers or its ASP has the authority to supersede them.

### Why is it essential to download the KENT Service Application?

1. Customer can lodge a service request/complaint anytime (24x7).
2. The customer can track/monitor the progress of service request/complaint.
3. Complete case history of the services done can be viewed.
4. Regular feedback & offer details on the App.



To download the App  
scan the QR code



To,

**KENT RO SYSTEMS LTD.**

E-6, 7 & 8, Sector-59, Noida, U.P.-201 309, India.

Ph.: 92-789-12345

E-mail: [service@kent.co.in](mailto:service@kent.co.in) | Website: [www.kent.co.in](http://www.kent.co.in)

## Water Flow Diagram

S.NO.	SP - CO.	ITEM DESCRIPTION
1	20035	LOW PRESSURE SWITCH
2	20010	SEDIMENT FILTER
3	20028	SOLENOID VALVE
4	20005	BOOSTER PUMP
5	20009	ACTIVATED CARBON FILTER
6	20002	RO MEMBRANE
7	20034	TDS CONTROL VALVE
8	20018	FLOW RESTRICTOR TUBE
9	20004	UF MEMBRANE
10	20058	NON RETURN VALVE
11	20148	WATER STORAGE TANK
12	20029	FLOAT MICRO SWITCH

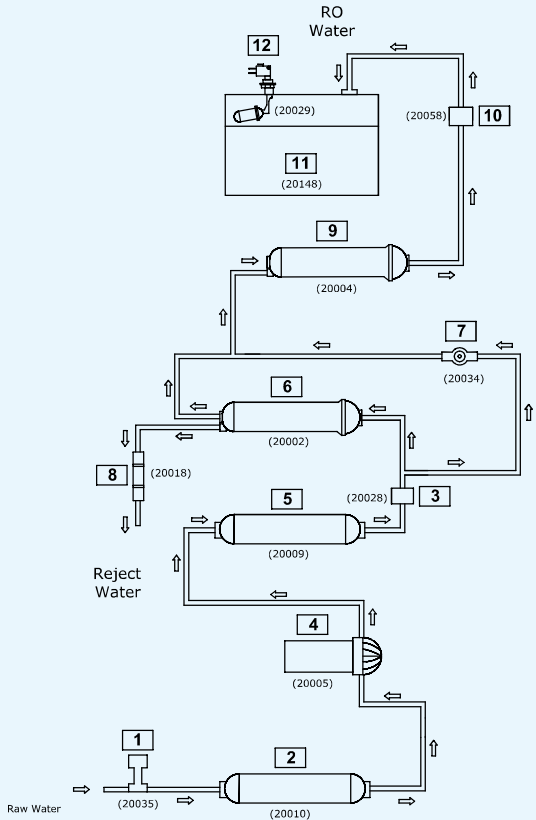

## Electrical Circuit Diagram

S.NO.	SPARE PART CODE	ITEM DESCRIPTION
1	20016	SMPS
2	20035	LOW PRESSURE SWITCH
3	20029	FLOAT MICRO SWITCH
4	20028	SOLENOID VALVE
5	20005	BOOSTER PUMP
6	20059	PUMP HEAD

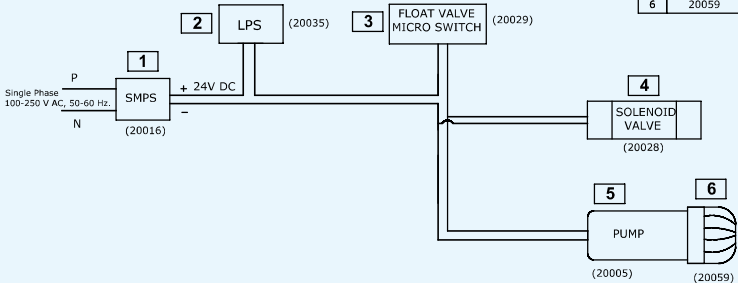

## Installation Report

Product : **KENT PRIDE TC**

Serial No.:

Customer's Name: \_\_\_\_\_

Customer's Address: \_\_\_\_\_

Customer's Ph.: \_\_\_\_\_

TDS of Purified Water: \_\_\_\_\_

Customer's Signature: \_\_\_\_\_

Invoice No.: \_\_\_\_\_

Invoice Date: \_\_\_\_\_

Installation Date: \_\_\_\_\_

Service Provider's Name: \_\_\_\_\_

Service Provider's Address: \_\_\_\_\_

Service Provider's Ph.: \_\_\_\_\_

TDS of Raw Water: \_\_\_\_\_

Service Provider's Stamp: \_\_\_\_\_

By signing this installation report, the customer agrees to the terms & conditions of the warranty mentioned on the back of the warranty card.

## Automatic Operation

- The purifier automatically shuts off when the storage tank is full
- The purifier does not start if the inlet water supply pressure drops below 0.3 kg/cm<sup>2</sup>
- The purifier automatically restarts when the water level drops below the maximum
- The purifier does not allow any water rejection in absence of electricity / when the tank is full

## Installation Instructions

**KENT Pride TC Mineral RO™ Water Purifier** is a convenient and easy-to-install wall mounting model.

### Recommended Site Preparations:

- Single Phase 100-250 V AC, 50-60 Hz. not more than 3m away from the point of installation
- Raw water supply with ½ inch nipple not more than 3m away
- Drain for the reject water not more than 3m away
- Installation space as per the dimensions of the purifier
- Wall / plane surface for mounting screws and holding the machine. Avoid installation on wooden and metallic stands
- For optimum inlet pressure the source water tank should be at least 10 ft. above the purifier installed
- Install the purifier near a sink for easy availability of inlet and reject water lines
- The system and installation must comply with state and local laws and regulations

### Installation Procedure:

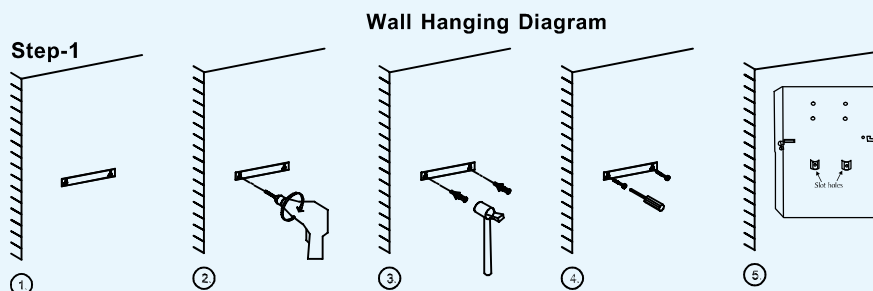

1. Paste the central drill sticker on the wall at (3.6 feet to 4.0 feet from the ground) as per your convenience.
2. Ensure that sticker is pasted straight on the wall, then drill holes as per the space provided on the sticker.
3. Now, insert the puff up with the help of a hammer.
4. Screw in two 10X50 self-taping screws, 5.4 inches (138 mm) apart horizontally.
5. Carefully hang the purifier on the wall with the help of the wall-mounting slot holes provided on the back of the purifier.

### Note:

1. If the wall is not straight or the screws are not properly drilled in an even position, it will damage your purifier.
2. Keep the device away from heat or direct sunlight.

### Step-2

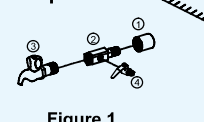

Figure 1.

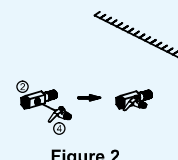

Figure 2.

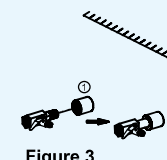

Figure 3.

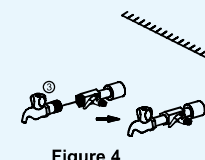

Figure 4.

1. First fix the SS ball valve (marked as no. 4) to the ¼ inch port of the 3-way connector (marked as no.2) as shown in Figure 2.
2. Connect the 3-way connector to the raw water supply (marked as no. 1) as shown in Figure 3. The 3-way connector is fitted in line with the raw water supply.
3. The other end of the 3-way connector can be connected to a tap (marked as no.3) as shown in Figure 4. or can be plugged off if not required.

### Step-3

1. Now connect one end of the white pipe to the SS ball valve and the another end to the upper push-fit elbow fitting to the left hand side of the purifier labelled WATER IN, as shown in Figure 1.
2. Similarly, connect one end of the white pipe to the lower elbow fitting connector in the tank labelled REJECT WATER and leave the other end in the drain, as shown in Figure 2.

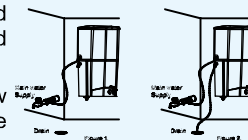

Figure 1.

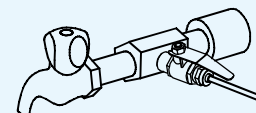

Figure 2.

### Step-4

Before connecting the power supply, it is important that you perform the following functions:

1. Open the SS ball valve (handle parallel to the ball valve) to start the flow of water into the purifier, as shown in the figure.
2. Wait for 2-3 minutes to ensure that the filters are soaked in water.



### Step-5

1. Connect the power supply.
2. Installation is complete.

## TDS Adjustment\*

The unique TDS Control System enables customers to retain the contents of natural minerals (TDS) in the purified water, as per their requirement.

- Turning the screw of the valve anti-clockwise, results in increased mineral content
- Turning the screw of the valve clockwise, results in decreased mineral content



We recommend keeping the TDS at lowest possible level but not below 50mg/l.

\* Tested & certified by TUV-SUD South Asia (P) Ltd.

## Starting-up the Purifier

- Switch on the power supply
  - Allow the storage tank to fill to its maximum capacity\*\*
  - Switch off the power supply
  - Open the drain plug present at the bottom of the storage tank and drain the tank completely. This would remove
- the residual dust particles present in different pipes and storage tank
  - Plug back the drain plug
  - Switch on the power supply
  - The purifier is now ready to use

## Recommended Usage of Rejected Water

Although the rejected water has high concentration of salts, it is absolutely clean and free from impurities such as chlorine, dirt, sand, etc. This rejected water usually goes down the drain but can be used for gardening

purposes. The high concentration of salts and minerals accelerates the plant growth. Rejected water can also be used for cleaning utensils, mopping etc.

## Maintenance

To ensure that the purifier operates at its BEST, routine maintenance must be performed. Frequency of the maintenance will greatly depend upon the raw water quality and consumption of purified water.

- The storage tank must be drained once in 2 weeks. Open the drain plug present at the bottom of the storage tank and drain the tank completely. Plug back the drain plug and switch on the power supply
- Replace the sediment filter & activated carbon filter once in 12 months. It is recommended to change the FRT along with the filters
- Replace the RO membrane once in a year
- Replace the UF membrane once in a year
- In the event of not using purifier for a long time (while going for a holiday, tour etc.), make sure that you disconnect the power supply, turn off the raw water supply and drain the storage tank



The replacement time of consumables such as filters and membrane is dependant on the quality of raw water and the quantity of purified water consumed.



Use genuine Kent spares for optimum performance.

The reverse osmosis system contains a replaceable treatment component critical for the effective reduction of totally dissolved solids and that product water is tested periodically to verify that the system is performing properly.

\*\* Tested & certified flushing time - 24hrs.

## Replacement of spare parts are as under:-

-20010	SP Inline Sediment Filter 8"
-20009	SP Inline Carbon Filter 8"
-20002	SP RO Membrane Welded 8" Housing
-20004	SP UF Membrane Welded 8" Housing
-20018	SP FRT 550/600

**Note:** Filters and membrane are consumables. Their replacement time is dependent on the quality of raw water and water consumption. They are not covered under the warranty. However, if a filter chokes within six months and a membrane within a year, it will be cleaned/repared/replaced free of cost. Changing the filters and system inspection is available on call. The treatment capacity of the RO membrane will reduce with time due to clogging of pores of membranes.

"This reverse osmosis system contains a replaceable component critical to the efficiency of the system. Replacement of the reverse osmosis component should be with one of identical specifications as defined by the manufacturer, to ensure the same efficiency and contaminant reduction performance."

## Important Safety Instructions

- If the supply cord is damaged, it must be replaced by the manufacturer, its service agent or similarly qualified persons in order to avoid hazard
- Children should be supervised to ensure that they do not play with the appliance
- This appliance is not intended for use by persons (including children) with reduced physical, sensory or mental capabilities, or lack of experience and knowledge, unless they have been given supervision or instruction concerning use of the appliance by a person responsible for their safety



## Technical Specifications

Product	KENT PRIDE TC
Product Code	11087
Product Generic Name	Water Purifier
Product Colour	White
Applications	Suitable for purification of brackish/tap water/ municipal corporation water
Purification Production Rate	15 L/hr.*
Body Material	ABS Food Grade Plastic
Mounting	Wall-mounted
Product Dimensions (mm)	380 (L) x 270 (W) x 505 (H)
Inlet Water Pressure/Temp. (Min.)	0.3 kg/cm <sup>2</sup> /10°C
Inlet Water Pressure/Temp. (Max.)	4 kg/cm <sup>2</sup> /40°C
Min./Max. Operating pH	6.5-8.0
Filter Cartridge	Sediment, Activated Carbon
Membrane Type	Thin Film Composite RO
UF Membrane	0.1 – 0.01 Microns
Net Weight	7.35 kg
Storage Capacity	8L
Maximum Duty Cycle	75 L/day
UF Filter	Ultra Filtration Membrane
Booster Pump Voltage	24 V DC
Total Power Consumption	60 W
Input Power Supply	Single Phase 100-250 V AC, 50-60 Hz. 
IP Rating	IPX1

\* Purification capacity tested on raw water having TDS level of 750 ppm at room temperature.